

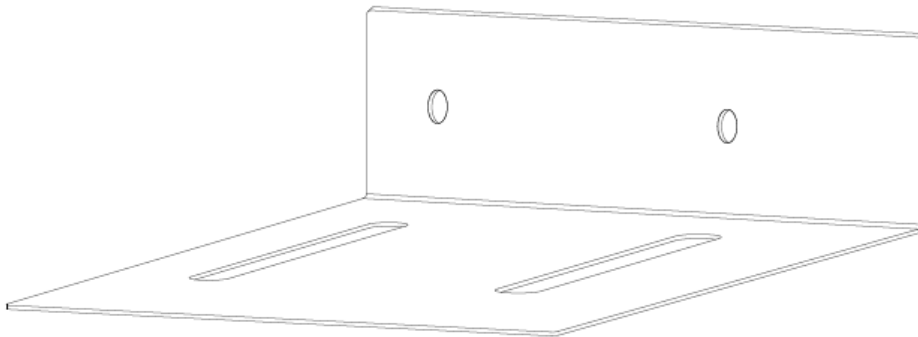

396 Attwell Drive, Toronto, Ontario. M9W 5C4
TEL: (416)742-7642 FAX: (416)742-9438 order@dcm-metal.com

Product Data Sheet Top Deflection Clip



- Used on exterior curtain wall studs to allow for building structure deflection at the top of the wall
- Top Deflection Clips can also be used for non-load bearing interior wall requirements
- Deflection Clips can also be used for non-load bearing interior wall requirements
- Allows for up to 1.5" deflection (0.75" in each direction)
- Available in two sizes with two slots to accommodate 3 5/8" and 4" studs or three slots to accommodate 6" and 8" studs
- Designed with pre-punched holes to ensure correct fastening locations
- Can be used with Slotted Track where required
- Top Deflection Clips can be attached to the main structure as specified by the engineer of record
- 68 mils, 50ksi, G-60 minimum

Manufactured in accordance to: CAN/CSA S-136-16 (North American specification for the design of cold-formed steel structural members), ASTM A653/A653M (Standard for steel sheet, zinc-coated (galvanized) or zinc-iron alloy-coated by the hot-dip process), ASTM C645 (Standard specification for non-structural steel framing members).
